

We're here to help. Your questions answered.

Get in touch

Please submit your views and comments online by scanning the QR code or visit:

<https://scnv.io/evcpconsultation>

before **5 May 2025**.

If you are unable to give feedback online, please call our customer care team on **03456 009 009**.

Email contactcentre@surreycc.gov.uk, SMS **078600 53465**,

or Textphone **18001 03456 009 009** (via text relay).

To find out more about the current proposed locations of chargepoints, please scan the QR code or visit: www.connectedkerb.com/surrey.

The proposed location can be seen below:

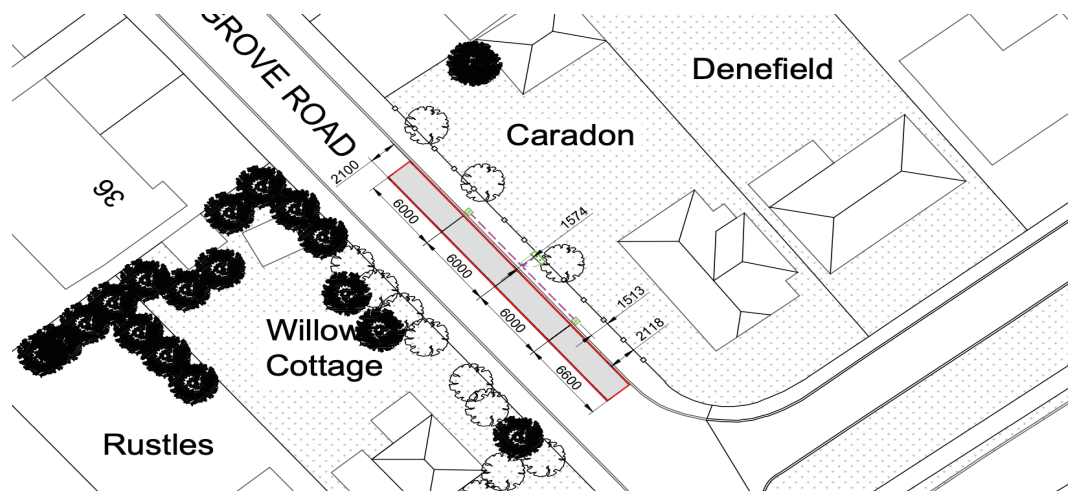

Important information about new electric vehicle chargepoints on your street.

Dear Resident,

Surrey County Council is working with Connected Kerb to install electric vehicle chargepoints across Surrey. You are receiving this information leaflet to inform you about updated plans to install chargepoints near you. We have had to make a minor adjustment to the original proposed position due to traffic regulations.

Why do we need to install EV chargepoints?

In 2030, the UK government is banning the sale of new petrol and diesel vehicles. This is to support the move to more environmentally-friendly options and reduce our reliance on fossil fuels. More public EV chargepoints are needed ahead of this to support people wanting to switch to an EV now. 40% of households do not have access to a driveway at home, and therefore a network of public chargepoints is required so people without driveways can charge their EVs easily and conveniently.

Why was this location chosen?

We have selected locations to install EV chargepoints either because one of your neighbours has requested one in this area, or because this area has been identified as not having current nearby access to public chargepoints, along with being an area with a number of residential properties with no access to off-street parking, or a community focal point with high usage and convenience for people to charge their EVs.

Connected___Kerb

Working in partnership with



I don't have an EV, will I still be able to park my car?

We're not proposing to change any of the parking restrictions at the moment, so other cars will still be able to park there, although we hope people will be considerate and allow EV drivers to charge. Any future change to parking restrictions would go through the normal consultation process.

What will the chargepoints look like?

The discreet 'Chameleon' 7kW chargepoints or slow 3kW chargepoints have been designed to be small and unobtrusive on the pavement or fitted onto lighting columns.

Where there is insufficient pavement width, we would create a build-out area instead to house the 7kW chargepoints. Each 7kW chargepoint has two sockets, to allow two EVs to charge at the same time.

There will also be a feeder pillar, to house the electrics, similar to other electrical boxes you see on pavements.



Why switch to an electric vehicle?

EVs boast lower running and maintenance costs with an easier and more convenient drive. With a growing second-hand market and more workplace car leasing schemes, long-term lease options, government grants and vehicle tax exemptions, EVs are becoming more affordable. Lower emissions from EVs means cleaner air for everyone.

Who is funding the installation and maintenance?

Connected Kerb are funding the great majority of chargepoint installations but will also seek to use funding and grants from central government to support the installation of EV chargepoints across the county.

How can I suggest a chargepoint location?

If you would like to suggest a location for an EV chargepoint or learn more about the project, please go online to: www.surreyev.commonplace.is

Where does the electricity come from?

Renewable energy sources primarily from wind, solar and hydro (water) sources will power 100% green electricity supplied by Octopus Energy.

How do I find the locations of other chargepoints?

Download the Connected Kerb app via the Appstore or Google Play. Also find them on www.zap-map.com.

Electric Streets

Connected Kerb and Vauxhall are joining forces to make it easier for you to go electric with their fully electric vehicle range! Vauxhall are supporting communities to have a voice in promoting public charging infrastructure via electricstreets.co.uk.

